



**Thato Molefe**  
084 038 7152  
thato@remax-  
advantage.co.za

Contact RE/MAX-Advantage  
(Rosebank)

011 4476763

247 Jan Smuts Avenue, Dunkeld West 2196

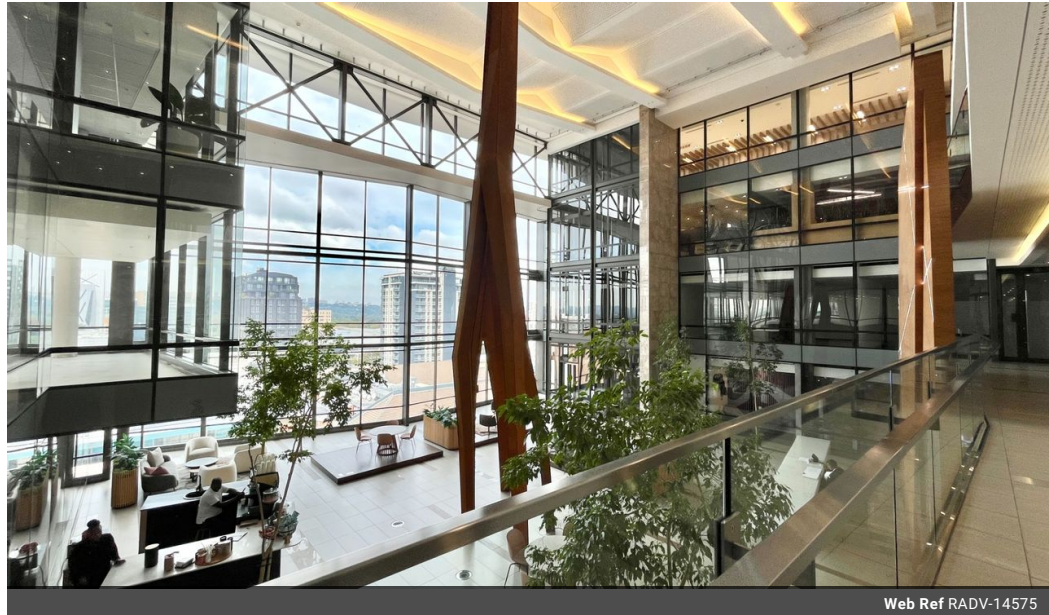

Web Ref RADV-14575



R pm



0



0

## Commercial Property To Rent in Rosebank, Johannesburg

Located in the prestigious Rosebank Towers at 19 Biermann Avenue, this exceptional office space, ideal for businesses seeking to thrive in the heart of Rosebank. The prime location ensures excellent connectivity, with proximity to vibrant shopping centers, restaurants, and convenient public transport links, making it a perfect choice for your business.

### Key Features:

- **Size:** 1033m<sup>2</sup> of adaptable office space, ready for immediate occupancy.
- **Rental:** R230 per m<sup>2</sup>.
- **Prime Location:** Close to top-tier amenities, shopping centers, and public transport.
- **Office Layout:** The space includes a spacious reception area, a waiting room, 4 meeting rooms (each able to

## Features

**Zoning** Commercial

### Sizes

Floor Size 726m<sup>2</sup>  
Land Size 1,033m<sup>2</sup>